

Lower Eyelid Spacer - Large

- Lower eyelid shape
- Provides internal support in cases of lower eyelid retraction
- Superior strip has smaller pore structure for a smoother edge
- Save time and expense of harvesting auricular or hard palate graft material
- Fully porous to promote tissue ingrowth and facilitate implant stabilization
- Easy to trim with scissors or scalpel
- Individually packaged, MR Safe, Sterile, 5 Year Shelf Life

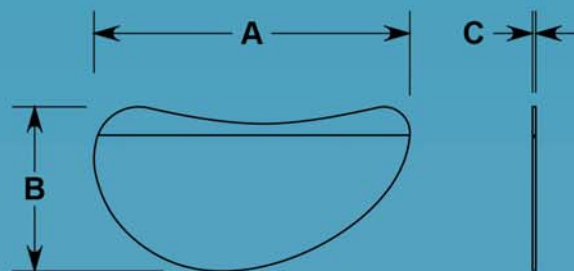

CAT#	Description	A	B	C
4438	Lower Eyelid Spacer w Superior Strip - Large	43mm	22mm	0.45mm

